



# I39-210 Gigabit High Power PoE Injector

## Quick Installation Guide

P/N: A625010400G

### INTRODUCTION

Model	Description
I39-210	90W high power PoE output

### PACKAGE CONTENTS

* 1x PoE injector
* 1x Quick Installation Guide

### ⚠ IMPORTANT:

1. Use CAT5 or 5e UTP/STP cables.
2. AC input (100~240V/AC, 50~60Hz,3A)

### CONNECTION

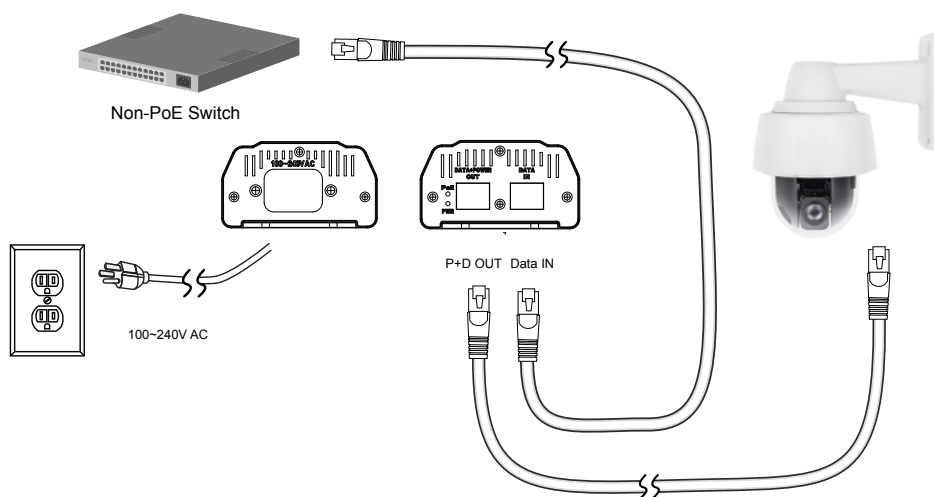

### Installation Steps:

1. Connect the included AC power cord to the injector. The Power LED (Yellow) should be lit.
2. Connect the Data IN port to a LAN switch using an Ethernet cable.
3. Connect the Power+Data OUT port to a powered device, i.e., IP camera, using another Ethernet cable. Make sure the PoE LED (Green) is lit.
4. Check if the powered device (IP camera) is working properly. An IP camera may take up to 1 or 2 minutes to power up.

All specifications are subject to change without notice.  
Copyright © 2020 AETEK INC. All rights reserved.

AETEK INC.  
3F, No.192, Lien-Cheng Rd., Chung-Ho, New Taipei City, 235, Taiwan, R.O.C.  
| T: +886-2-82452822 | W: [www.aetektec.com](http://www.aetektec.com) | E: [sales@aetektec.com](mailto:sales@aetektec.com)